

CENTER 1 SLIM
FUNCTIONAL TRAINER



IDEATION



ORIGINAL PRODUCT



HOLISTIC USER

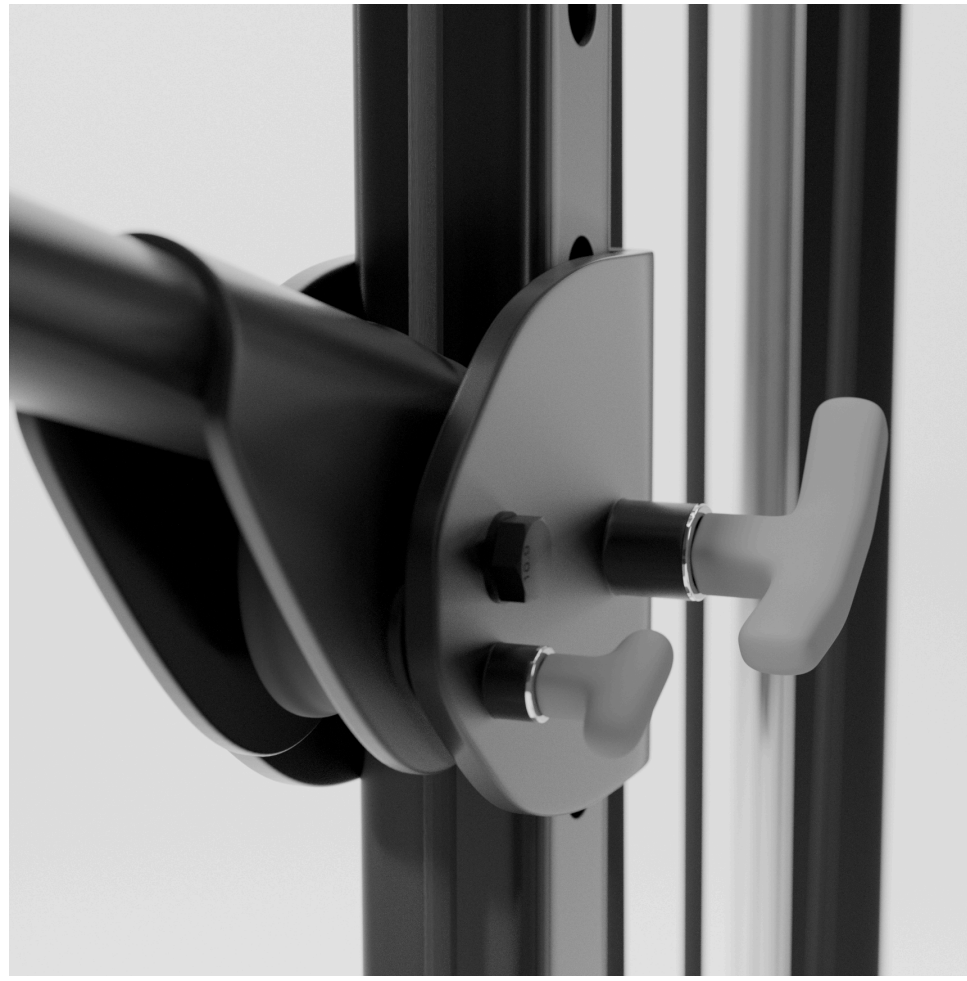

BILL OF MATERIALS



#	ITEM	MATERIAL	FINISH	Count
-	50mm M10 x 1.5 Bolt	Class 10.9 Steel	Black oxide	9
-	M10 x 10.5 x 18 Washer	Steel	Black oxide	12
-	M10 x 1.5 Nut	Steel	Black oxide	3
A	1/4" Steel Round	Steel	Powder Coat	8in
B	12 Gauge 2in x 1in Square Tube	Steel	Powder coat	6.5ft
C	12 Gauge 1in Round Tube	Steel	Powder Coat	3ft
D	Seat Cover	PU Leather	-	1yd
E	1in Foam	EPU	-	6ft ²
F	12 Gauge sheet metal	Steel	Powder coat	1.5ft ²
G	Feet	Rubber	-	4

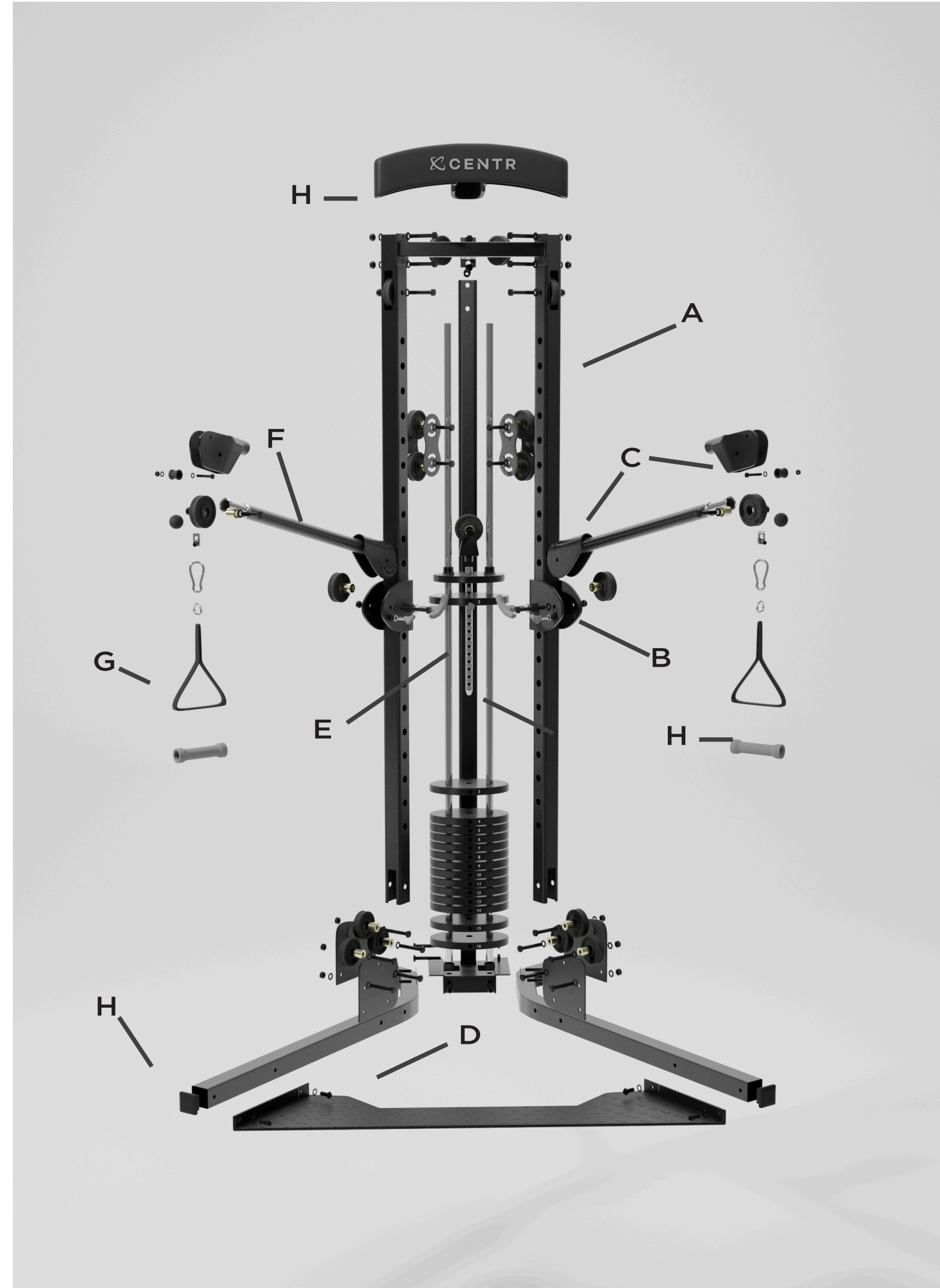

#	ITEM	MATERIAL	FINISH	COUNT
-	75mm M10 x 1.5 Bolt	Class 10.9 Steel	Black oxide	28
-	M10 x 10.5 x 18 Washer	Steel	Black oxide	52
-	M10 x 1.5 Nut	Steel	Black oxide	48
-	M10 x 10.5 x 15 Washer	Steel	Black Oxide	8
-	25mm M10 x 1.5 Hex Bolt	Class 10.9 Steel	Black Oxide	8
-	50 mm M10 x 1.5 Bolt	Class 10.9 Steel	Black Oxide	4
A	12 Gauge 2in Square Tube	Steel	Powder Coated	-22.5ft
B	1/4" Sheet Metal	Steel	Powder Coated	2ft ²
C	12 Gauge Sheet Metal	Steel	Powder Coated	3ft ²
D	Diamond Plate 1/16"	Aluminum	Anodized	4ft ²
E	3/4" Polished Tubing	Stainless Steel	-	14ft
-	Oil-Embedded Sleeve Bearing	Copper	-	19
-	3in Pulley	Nylon	-	19
F	1in 12 Gauge Round Tube	Steel	Powder Coated	41 in
G	3/4" Webbing	Nylon	-	3ft
-	Carabiner	Zinc-plated steel	-	2
-	1" D-Ring	Zinc-plated steel	-	2
H	Injection Molded Plastic	HDPE	-	-



CENTR

CENTR 1 SLIM FUNCTIONAL TRAINER

DESIGNED FOR THE HOLISTIC USER. MODELED
AND RENDERED IN BLENDER